



7

Sanitary fixings

- Toilet / Bidet fixings 3
- Washbasin and urinal fixings 5
- KM / WDP fixings for board materials 7
- Sanitary retail range 8



Complete fixing sets for free-standing toilets and bidets



Free-standing toilets

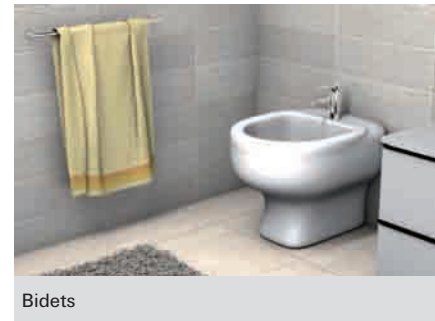

Bidets

BUILDING MATERIALS

- Concrete
- Solid sand-lime brick
- Natural stone with dense structure
- Solid block made from lightweight concrete
- Solid brick
- Timber - disgregard nylon plug.

CHARACTERISTICS



ADVANTAGES

- Complete fixing sets including brass screws which allow for quick and easy installation.
- The large flange prevents contact between the screw and ceramic to reduce the likelihood of damage during fixing.
- The WB5N's assembly bracket, with pre-drilled rows of holes, allows for adjustable installation in two directions.
- The WCN is also suitable for fixing ceramic shelves and mirrors, and can thus be used for a wide range of applications.

APPLICATIONS

- Free-standing toilets
- Bidets
- Ceramic shelves
- Mirrors
- Side fixing pans & semi-pedistals - use WB5N

FUNCTIONING

- S 8 RD is for push-through installation.
- WCN and S 8 D are suitable for both pre-positioned and push-through installation.
- The WB5N's assembly bracket is positioned using the slotted hole. The ceramics can then be fixed to the bracket via rows of holes. These allow for tolerances that may occur during the ceramic manufacturing process.

INSTALLATION

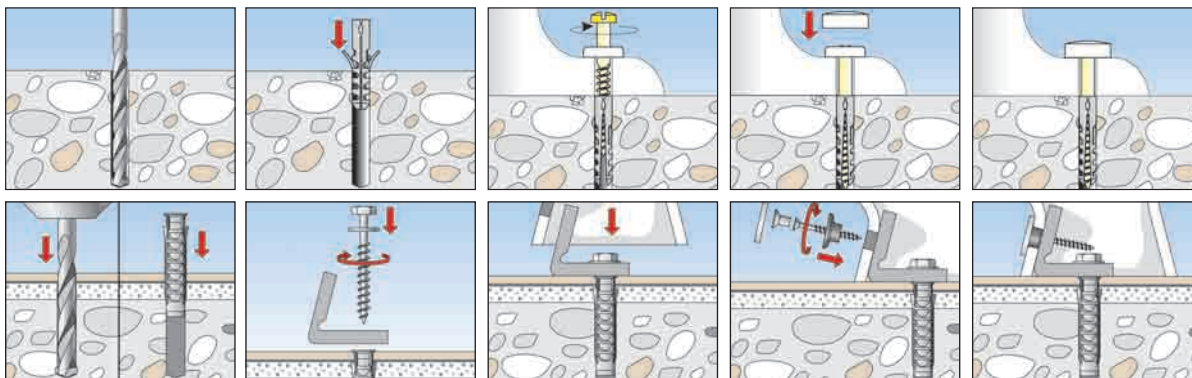

TECHNICAL DATA



WCN

Item to order only	Art.-No.	Contents per plastic bag	Sales unit
Item	[pcs]		[pcs]
WCN 1	060561	2 wall plugs S 8, 2 brass screws 6 x 70 6kt., 2 cover caps white, 2 snap-fit sleeves	50
WCN 2	060562	2 wall plugs S 8, 2 brass screws 6 x 70 6kt., 2 cover caps chrome, 2 snap-fit sleeves	50

TECHNICAL DATA



S 8 D 70 WCR

Items to order only	Art.-No.	Contents per plastic bag	Sales unit
Item	[pcs]		[pcs]
S 8 D 70 WCR	060564	2 wall plugs S 8, 2 brass screws 6 x 70 6kt., 2 cover caps chrome and white, 2 snap-fit sleeves	50

TECHNICAL DATA



S 8 RD WCR

Items to order only	Art.-No.	Contents per plastic bag	Sales unit
Item	[pcs]		[pcs]
S 8 RD 60 WCR	060570	2 wall plugs S 8 RD 60, 2 brass screws 5,5 x 65 6kt., 2 cover caps in chrome and white	50
S 8 RD 80 WCR	060568	2 wall plugs S 8 RD 80, 2 brass screws 6 x 85 6kt., 2 cover caps in chrome and white	50
S 8 WC 80	42922	2 wall plugs S 8 RD 80, 2 brass screws 6 x 85 6kt., 2 cover caps in white	50

TECHNICAL DATA



WC fixing **WB 5N**

Items to order only	Art.-No.	Contents	Sales unit
Item	[pcs]		[pcs]
WB 5N	018652	2 S-plugs, UX 10, 2 screws 7x65 zinc-plated, 2 nylon brackets, 2 washers 8mm, 2 screws A2 stainless steel, 2 flanged sleeves, 2 cover caps chrome	50
WB 5N	42914	2 S-plugs, SX 10, 2 screws 7x65 zinc-plated, 2 nylon brackets, 2 washers 8mm, 2 screws A2 stainless steel, 2 flanged sleeves, 2 cover caps in chrome and white	50

Complete fixing sets for wash basins, urinals and sanitary installations



WD

WST



Urinals



Wash basins

BUILDING MATERIALS

Fixing dependant, when using S-Plugs:

- Concrete
- Solid sand-lime brick
- Natural stone
- Solid block made from lightweight concrete
- Solid brick

CHARACTERISTICS



When using UX Plugs:

- Gypsum plasterboard and gypsum fibreboards
- Vertically perforated brick
- Hollow block made from lightweight concrete
- Cavity floor slabs made of brick, concrete, etc.
- Perforated sand-lime brick
- Natural stone
- Aerated concrete
- Chipboard
- Solid panel made from gypsum

ADVANTAGES

- Complete fixing sets for quick and easy installations.
- The UX universal plug can be used in all solid, hollow and board materials offering a high level of flexibility.
- Flanged nuts and collar sleeves made of high-strength nylon are resistant to ageing and chemicals and guarantees a long-lasting fixing that will not damage the ceramics.
- Cover caps* with a high-quality chrome finish ensure the fixture remains visually attractive for a long period of time. (*cover caps sold separately)

APPLICATIONS

- Wash basins
- Urinals
- Built-in toilets
- Boilers
- Gas heaters
- Cisterns

FUNCTIONING

- The UX plug without a rim is suitable for pre-positioned and push-through installations.
- Tightening the screw causes the UX to expand in the solid building material and to form a knot within the cavity.
- Maximum load-bearing capacity is only achieved when the screw is tightened so that the spanner flat lies on the plug rim.
- Tiles and plaster are not classed as load-bearing base materials.
- KM & WDP fixings sets are specially designed for fixing washstands and urinals to plumbing units and cavity walls

INSTALLATION

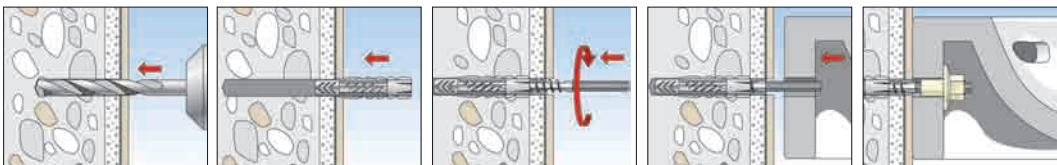

TECHNICAL DATA



WD - Wash basin and urinal fixing

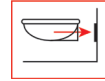

Item	Art.-No.	Contents per plastic bag [pcs]	Sales unit [pcs]
WD 8 x 90	080659	2 wall plugs UX 10 x 60, 2 stud screws M 8x90 zinc-plated, 2 flanged nuts BU M8, installation instructions	50
WD 8 x 110	080658	2 wall plugs UX 10 x 60, 2 stud screws M 8x110 zinc-plated, 2 flanged nuts BU M8	50
WD 10 x 120	080655	2 wall plugs UX 14 x 75, 2 stud screws M 10x120 zinc-plated, 2 flanged nuts BU M10, installation instructions	50
WD 10 x 140	080656	2 wall plugs UX 14 x 75, 2 stud screws M 10x140 zinc-plated, 2 flanged nuts BDH M10, 2 hexagon nuts M10, installation instructions	50

TECHNICAL DATA



WST Wash basin fixing



WST Wash basin fixing



Items to order only	Art.-No.	Contents per plastic bag [pcs]	Sales unit [pcs]
WST 10 x 140	080660	2 wall plugs UX 14 x 75, 2 stud screws M 10x140 zinc-plated, 2 flanged nuts BDH M10, 2 hexagon nuts M10, installation instructions	50
WST 12 x 150	080661	2 wall plugs UX 14 x 75, 2 stud screws M 12 x 150 zinc-plated, 2 hexagon nuts M 12 zinc-plated, 2 flanged bushes BDH M 12	50
WST 12 x 180	080662	2 wall plugs UX 14 x 75, 2 stud screws M 12 x 180 zinc-plated, 2 hexagon nuts M 12 zinc-plated, 2 flanged bushes BDH M 12	50
WST 140	42909	2 wall plugs S 14 x 75, 2 stud screws M 10x140 zinc-plated, 2 flanged nuts BDH M10, 2 hexagon nuts M10, installation instructions	50
WST 120	42907	2 wall plugs S14 x 75, 2 stud screws M 12 x 150 zinc-plated, 2 hexagon nuts M 12 zinc-plated, 2 flanged bushes BDH M 12	50

TECHNICAL DATA



WL - W.C. & sanitary fixing



WLL - W.C. & sanitary Fixing



Items to order only	Art.-No.	Contents per plastic bag [pcs]	Sales unit [pcs]
WL 7 x 60	080651	2 wall plugs UX 10, 2 screws 7 x 65 hex. head zinc-plated, 2 washers zinc-plated	100
WL 8 x 70	080652	2 wall plugs UX 10, 2 screws 8 x 70 6kt. DIN 571 zinc-plated, 2 washers zinc-plated	100
WL 10 x 70	080650	2 wall plugs UX 12, 2 screws 10 x 70 6kt. DIN 571 zinc-plated, 2 washers zinc-plated	50
WLL 7 x 60	42919	2 wall plugs S 10, 2 screws 7 x 65 hex. head zinc-plated, 2 washers zinc-plated	50
WLL 8 x 70	42920	2 wall plugs S10, 2 screws 8 x 70 6kt. DIN 571 zinc-plated, 2 washers zinc-plated	50
WLL 10 x 70	42921	2 wall plugs S 12, 2 screws 10 x 70 6kt. DIN 571 zinc-plated, 2 washers zinc-plated	50

ACCESSORIES



BU M Flanged nut



Cover cap **AKM**

Items to order only	Art.-No.	Thread Ø x length [mm]	Width across nut ○ SW [mm]	Washer [mm]	Fits	Sales unit [pcs]
BU M 8 MH	060200	M 8	17	40	STST M8	25
BU M 10 MH	060201	M 10	17	40	STST M10	25
BU M 12 MH	060204	M 12	19	40	STS M 12	25

Items to order only	Art.-No.	Colour	Fits	Sales unit [pcs]
AKM 10 W	080972	white	BU M10 MH	20
AKM 10 CR	080951	chrome	BU M10 MH	100
AKM 12 CR	080952	chrome	BU M12 MH	100

Complete fixing sets for wash basins and urinals in board building materials and plumbing walls

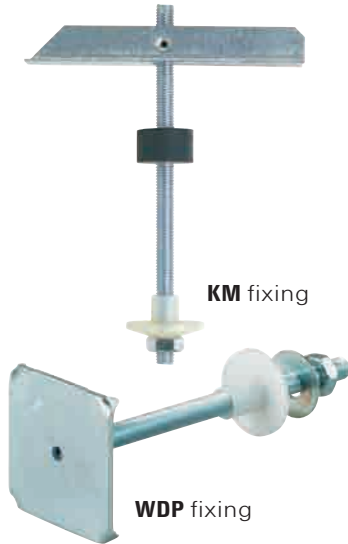

Urinals



Wash basins

BUILDING MATERIALS

- Gypsum plasterboard and gypsum fibreboards
- Chipboard

FUNCTIONING

- KM is suitable for push-through installation.
- When placed in the drill hole, the wide transition beam of the KM independently swings open behind the board.
- WDP is set into the plumbing walls during wall installation.
- Not suitable for fixing directly to plasterboard.

ADVANTAGES

- With their special geometries, KM and WDP are the specialists for fixings in plumbing and hollow walls.
- The wide cross beams of the KM and the large base plate of the WDP ensure a good load distribution, thus allowing for a high load-bearing capacity.

APPLICATIONS

- Wash basins
- Urinals

TECHNICAL DATA



WDP - Wash basin and urinal fixing

Item	Art.-No.	Thread Ø x length [mm]	Length l [mm]	Sales unit [pcs]
WDP 10 x 170	014320	M 10	170	10

TECHNICAL DATA

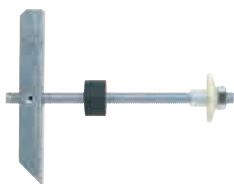

Gravity toggle KM 10

Items to order only	Art.-No.	Drill hole diameter d ₀ [mm]	Anchor length l [mm]	Min. cavity depth a [mm]	Max. panel thickness d _p [mm]	Screw d _s x l _s [mm]	Sales unit [pcs]
Item	050326	30	240	140	90	M 10 x 180	25

TECHNICAL DATA



WB9N - For wall hung WC's and wash basins



Bowl to wall

Item to order only	Art.-No.	Contents per plastic bag [pcs]	Sales unit [pcs]
WB9N kit	04013	2 x GFR Nylon bodies, 2 x M12 threaded sockets, 2 x caps (white) 1 x allen key	1

For use in concrete or solid brick

TECHNICAL DATA



CBB 1 - Small hand rinse/corner basin bracket fixing set

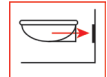

Basin to wall

Item	Art.-No.	Contents per plastic bag [pcs]	Sales unit [pcs]
CBB1	42832	2 x basin brackets, 2 x coachscrews 7 x 65mm, 2 x washers, 2 x wallplugs SX 10mm	10

TECHNICAL DATA



WB5N - W.C. Pan to floor side fixing set



Bowl to floor

Item	Art.-No.	Contents per plastic bag [pcs]	Sales unit [pcs]
WB5N	42831	2 x SX10 nylon plugs, 2 x zinc plated hex. screws 7 x 65mm 2 x zinc plated washers, 2 x countersunk nylon bushes 2 x brass drilled screws 5 x 30mm, 2 x nylon angle brackets 2 x flat white caps	10

TECHNICAL DATA



WB 10 - W.C. Pan to floor vertical fixing set



Bowl to floor

Item	Art.-No.	Contents per plastic bag [pcs]	Sales unit [pcs]
WB 10	42834	2 x SX 8 nylon plugs, 2 x drilled brass screws 5 x 85mm, 2 x countersunk nylon bushes, 2 x flat white caps 12mm, 2 x flat white caps 15mm, 2 x raised nylon bushes, 2 x raised white caps	10

TECHNICAL DATA

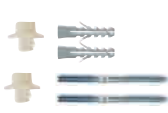

WD8 x100 - small hand rinse/corner basin bracket fixing set



Basin to wall

Item	Art.-No.	Contents per plastic bag [pcs]	Sales unit [pcs]
WD 8 x 100	42836	2 x S10 nylon wallplugs 2 x Zinc plated stud screws M8 x100mm 2 x nylon flanged nuts	10

TECHNICAL DATA



WBP 1 - wash basin with pedestal fixing set

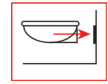

Basin to wall/Pedestal to floor)

Item	Art.-No.	Contents per plastic bag [pcs]	Sales unit [pcs]
WBP 1	42835	4 x SX 8 nylon plugs 2 x PD10 plasterboard fixings 4 x Zinc plated screws, 5 x 60mm 2 x countersunk nylon bushes 2 x raised nylon bushes	10

TECHNICAL DATA



WST 140 - wash basin fixing set



Basin to wall

Item	Art.-No.	Contents per plastic bag [pcs]	Sales unit [pcs]
WST 140	42833	2 x S 14 nylon plugs, 2 x Zinc plated stud screws M10x140mm 2 x nylon flanged bushes, 2 x Zinc plated hex. nuts M10s	10

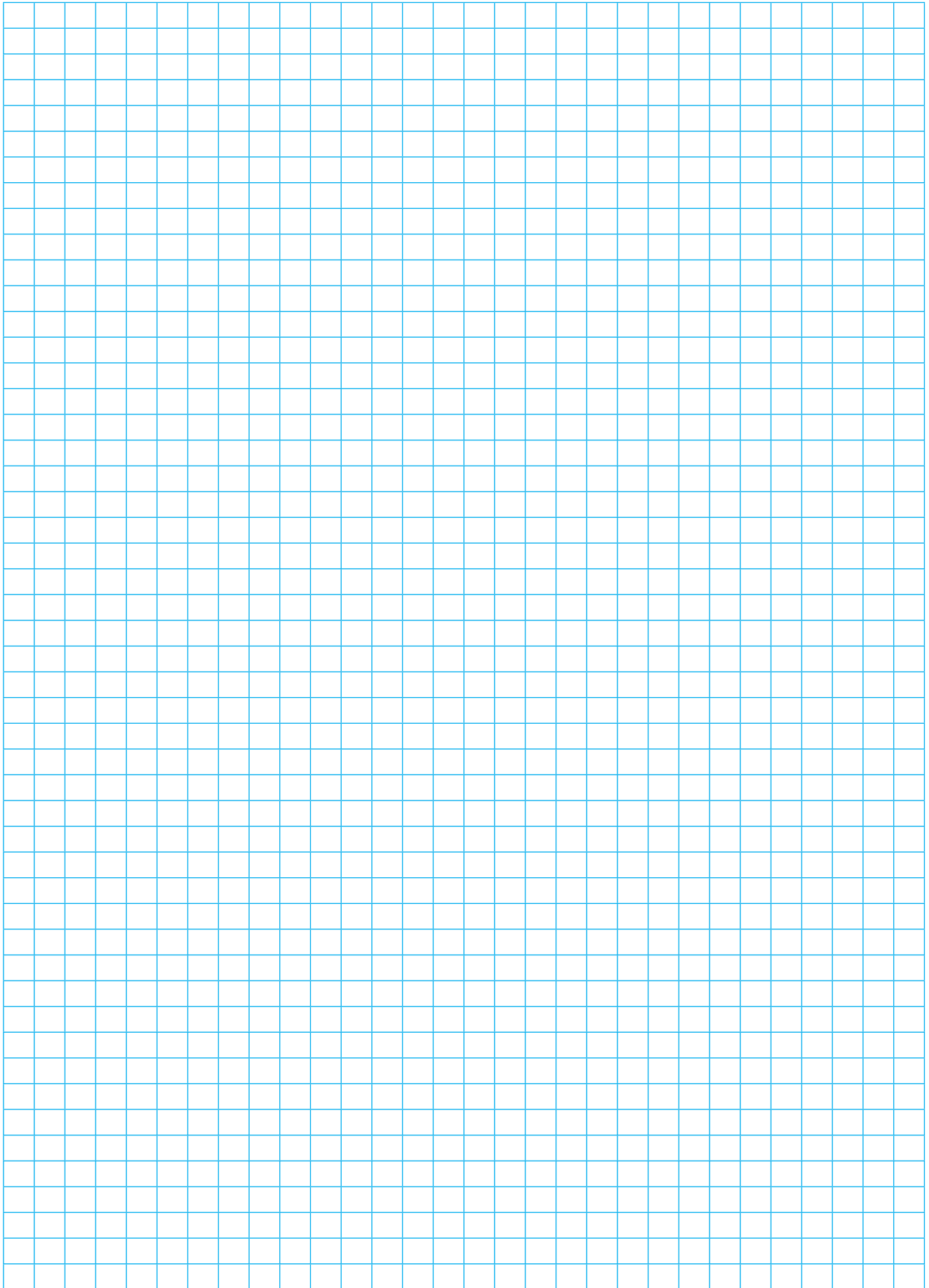

Technical disclaimer / Decisive factors

Due to the complexity of building materials, tools, fixing elements and installation techniques a comprehensive recommendation depends on full and detailed understanding of specific site conditions.

This document is a factual record of anchor performance obtained under specific conditions and does not constitute an endorsement of the suitability of the product for any specific application. This responsibility remains with the customer.

The data given shall be used as a guide for assessment or anchor suitability. Even when our advice is given in good faith it cannot be binding for this reason and we cannot accept any liability for any anchor failure due to the wrong design, misuse or wrong installation.

For safety critical applications only anchors with an ETA or Zulassung German Approval shall be used.

For further product information please contact the fischer Technical Department:

Phone: 01491 827 920

E-mail: technical@fischer.co.uk

fischer fixings (UK) Ltd.

Whitely Road, Wallingford, Oxon, OX10 9AT.

We cannot be responsible for any errors, and we reserve the right to make technical and range modifications without notice.

No liability is accepted for printing errors and omissions.

General Notice

The information in this brochure is intended for general guidance only and is given without engagement. Additional information and advice on specific applications is available from our Technical Support Team. For this however, we require a precise description of your particular application.

All the data in this brochure concerning work with our fixings must be adapted to suit local conditions and the type of materials in use.

If no detailed performance specifications are given for certain articles and types, please contact our Technical Service Department for advice.

Phone: 01491 827 920

E-mail: technical@fischer.co.uk

01/2013

Contacts

fischer fixings UK Ltd.
Whitely Road
Oxon OX10 9AT Wallingford
Great Britain
Phone (0044) 1491 827900
Fax (0044) 1491 827953
E-mail info@fischer.co.uk
www.fischer.co.uk

Your dealer:

Technical Service

If you need any assistance, simply contact your local fischer representative. For more specialised application problems please contact our Technical Services Team.

fischer fixings UK Ltd. Wallingford, Oxon, OX10 9AT.

Phone 01491 827 920
e-mail: technical@fischer.co.uk

Technical Training

We also offer training seminars suited to your individual needs and requirements. Please call the number above to find out more



www.fischer.co.uk



fischer  [®]
innovative solutions